

HGA9 PRO-S 双钩系列舞台电动葫芦

HGA9 PRO-S DOUBLE HOOK SERIES STAGE ELECTRIC CHAIN HOIST



含以下型号:

The following models are included:

■型号/MODEL: HGA9 Pro-S 500 ■型号/MODEL: HGA9 Pro-S 1000 ■型号/MODEL: HGA9 Pro-S 2000

🏭 制造商: 河北怀鸽起重机械集团有限公司

📍 地址: 河北省保定市清苑区东吕怀鸽工业园区

🏭 Manufacturer: HEBEI HUAIGE HOISTING MACHINERY GROUP CO.,LTD

✉ Email: export@huaigegroup.com

☎ 电话: 0312-8151581

📠 传真: 0312-8152866

☎ TEL: 0086-312-8151581

📍 ADDRESS: Huaige Industrial Park, Qingyuan County, Baoding City, Hebei Prov. China

🌐 网址: www.huaigeqz.com

📞 全国免费服务热线: 400-632-3580

🌐 Website: www.huaigegroup.com

CONTENTS 目录

1.产品简介	3
2.技术数据	4
2.1.标准配置	4
2.2.选装配置	4
2.3.线形图	7
2.3.产品爆炸图	10
3.电器数据	11

1.PRODUCT INTRODUCTION	3
2.TECHNICAL DATA	4
2.1.STANDARD VERSION	4
2.2.OPTIONAL CONFIGURATION	4
2.3.LINE GRAPH	7
2.3.PRODUCTS EXPLOSION VIEW	10
3.ELECTRICAL DATA	11



产品简介

- 铝合金外壳，坚实而质轻，有特殊散热片，可连续使用，适用于高频作业
- 整体封闭结构，防护等级IP55
- 一个机身，双钩设计，消除刹车惯性导致的不统一问题，吊钩间距可按需定做
- 吊钩是合金钢热锻成型，高强度、强韧性，不易断裂，下吊钩可360°旋转并附安全舌，确保安全
- 自带钢轨抱卡，适用于轨道安装以及固定安装，快捷方便
- 80级镀锌链条，坚固耐用，质量无忧
- 齿轮纯钢铸造，一体成型，齿口精度高，咬合力紧密，耐磨不断齿
- 上下触点式断电限位，超限自动停止运行，防止链条超出安全范围
- 电磁刹车，简单设计，断电即刻抱死，并配备急停按钮，有效防止突发状况

Product Introduction

- Aluminum alloy shell, solid and lightweight, with special heat sink, can be used continuously, suitable for high-frequency work
- The whole closed structure has an IP55 degree of protection
- One fuselage, double hook design, eliminate the problem of inconsistency caused by brake inertia, and the hook spacing can be customized on demand
- The hook is made of alloy steel hot forging, with high strength, strong toughness, not easy to break, and the lower hook can be rotated 360° with a safety tongue to ensure safe use
- It comes with a rail holder, which is suitable for track installation and fixed installation, which is fast and convenient
- Grade 80 galvanized chain, strong and durable, worry-free quality
- The gear is cast in pure steel, integrally formed, with high tooth precision, tight bite force, and continuous wear resistance
- The upper and lower contact type power-off limit, and the operation will be automatically stopped when the limit is exceeded, so as to prevent the chain from exceeding the safety range
- Electromagnetic brake, simple design, instant locking when power failure, and equipped with an emergency stop button to effectively prevent emergencies

标准配置:

- 设备型号: HGA9 Pro-S 500
- 起重量: 500 Kg
- 提升速度(m/min): 5/6.8
- 供电电压: 220-440V、3ph、50/60Hz (见P11)
- 控制电压: 36V 低压控制
- 供电电缆: 1m电源线, 带CEE-16A/4芯
- 链条尺寸 EN818-7(mm): 6.3*19
- 链条重量(Kg/m): 0.86
- 链条等级: G80
- 链条表面: 磷化 (黑)
- 链条行数: 2
- 导链器: 带有5个链窝链轮的精密导链器
- 链条袋: 1纺织链条袋, 可拆卸, ≤30米
- 双钩间距: 500-1300毫米(超出范围可单独定制)
- 满载噪音(dB): ≤65
- 制动器: 1个交流制动
- 吊钩: 2个下(可旋转)
- 悬挂方式: 可调节抱卡固定安装, 可选装运行跑车式
- 安装方式: 固定式
- 塑料手柄: 无
- 防护等级: IP55
- 不含链条的重量(kg): 64 - 83
- 电机功率(KW): 1.1
- 电流消耗(A): 3.1
- 机械等级/FEM9.511: 1Bm/25% ED
- 限位方式: 上下电子触点限位
- 颜色: 黑色, 色号RAL 9005 哑光

选装配置:

- **编码器选装** 安装增量式编码器或预留编码器安装位 (低速链轮输出轴或高速电机轴)
- **控制手柄选装** 低压4位开关
- **称重检测选装** 称重传感器
- **链条表面处理选装** 镀锌 (白)
- **高压控制选装** 选装 一条高压主电源控制

Standard Configuration

- Model : HGA9 Pro-S 500
- SWL acc. : 500 Kg
- Lifting speed (m/min) : 5/6.8
- supply voltage :
220-440V、3ph、50/60Hz (See P11)
- Control voltage: 36V low voltage control
- Power supply cable : 1m power supply cable, CEE-16A/4 cord
- Chain acc. EN818-7 (mm) : 6.3*19
- Chain net weight (Kg/m) : 0.86
- Grade of chain : G80
- Chain surface : Parkerized (black)
- Chain falls : 2
- Chain Guide : Precise chain guide with 5-pocket chain wheel
- Chain bag : 1 textile chain bag, detachable, ≤30 meters
- Double hook spacing: 500-1300mm(Outside the range can be customized individually)
- Full load noise level (db) : ≤65
- Brake: 1AC brake
- Load hook: 2-down / turnable
- Suspension: Adjustable holding card fixed installation, optional running sports car type
- Mounting position: stationary
- Plastic handles: without
- Protection level: IP55
- Weight without chain (kg): 64-83
- Motor power (KW) : ca.1.1
- Current consumption (A): ca.3.1
- Mechanism class /FEM9.511: 1Bm/ 25% ED
- Limit mode: Upper and lower electronic contact limit
- Color:black, RAL 9005 matt

Optional:

- **Encoder Optional** Incremental encoder or reserved encoder mounting position (low speed sprocket output shaft or high speed motor shaft)
- **Controlling handle Optional** Low voltage 4-position switch
- **Load detection Optional** Load cell
- **Chain surface treatment Optional** Galvanized (white)
- **High voltage control Optional** Install a high voltage main power supply to control

标准配置：

- 设备型号：HGA9 Pro-S 1000
- 起重量：1000 Kg
- 提升速度(m/min)：5/7
- 供电电压：220-440V、3ph、50/60Hz (见P11)
- 控制电压：36V 低压控制
- 供电电缆：1m电源线，带CEE-16A/4芯
- 链条尺寸 EN818-7(mm)：7.1*21
- 链条重量(Kg/m)：1.1
- 链条等级：G80
- 链条表面：磷化（黑）
- 链条行数：2
- 导链器：带有5个链窝链轮的精密导链器
- 链条袋：1纺织链条袋，可拆卸，≤30米
- 双钩间距：500-1500毫米(超出范围可单独定制)
- 满载噪音(dB)：≤65
- 制动器：1个交流制动
- 吊钩：2个下(可旋转)
- 悬挂方式：可调节抱卡固定安装,可选装运行跑车式
- 安装方式：固定式
- 塑料手柄：无
- 防护等级：IP55
- 不含链条的重量(kg)：83.5 - 116
- 电机功率(KW)：1.5
- 电流消耗(A)：3.7
- 机械等级/FEM9.511：1Bm/25%ED
- 限位方式：上下电子触点限位
- 颜色：黑色，色号RAL 9005 哑光

选装配置：

- **编码器选装** 安装增量式编码器或预留编码器安装位（低速链轮输出轴或高速电机轴）
- **控制手柄选装** 低压4位开关
- **称重检测选装** 称重传感器
- **链条表面处理选装** 镀锌（白）
- **高压控制选装** 选装一条高压主电源控制

Standard Configuration

- Model : HGA9 Pro-S 1000
- SWL acc.: 1000 Kg
- Lifting speed (m/min) : 5/7
- supply voltage :
220-440V、3ph、50/60Hz (See P11)
- Control voltage: 36V low voltage control
- Power supply cable : 1m power supply cable, CEE-16A/4 cord
- Chain acc. EN818-7 (mm) : 7.1*21
- Chain net weight (Kg/m) : 1.1
- Grade of chain : G80
- Chain surface : Parkerized (black)
- Chain falls : 2
- Chain Guide : Precise chain guide with 5-pocket chain wheel
- Chain bag : 1 textile chain bag, detachable, ≤30 meters
- Double hook spacing: 500-1500mm(Outside the range can be customized individually)
- Full load noise level (db) : ≤65
- Brake: 1AC brake
- Load hook: 2-down / turnable
- Suspension: Adjustable holding card fixed installation, optional running sports car type
- Mounting position: stationary
- Plastic handles: without
- Protection level: IP55
- Weight without chain (kg): 83.5-116
- Motor power (KW) : ca.1.5
- Current consumption (A): ca.3.7
- Mechanism class /FEM9.511: 1Bm/ 25% ED
- Limit mode: Upper and lower electronic contact limit
- Color:black, RAL 9005 matt

Optional:

- **Encoder Optional** Incremental encoder or reserved encoder mounting position (low speed sprocket output shaft or high speed motor shaft)
- **Controlling handle Optional** Low voltage 4-position switch
- **Load detection Optional** Load cell
- **Chain surface treatment Optional** Galvanized (white)
- **High voltage control Optional** Install a high voltage main power supply to control

标准配置:

- 设备型号: HGA9 Pro-S 2000
- 起重量: 2000 Kg
- 提升速度(m/min): 6
- 供电电压: 220-440V、3ph、50/60Hz (见P11)
- 控制电压: 36V 低压控制
- 供电电缆: 1m电源线, 带CEE-16A/4芯
- 链条尺寸 EN818-7(mm): 10*30
- 链条重量(Kg/m): 2.2
- 链条等级: G80
- 链条表面: 磷化 (黑)
- 链条行数: 2
- 导链器: 带有4个链窝链轮的精密导链器
- 链条袋: 1纺织链条袋, 可拆卸, ≤30米
- 双钩间距: 500-1500毫米(超出范围可单独定制)
- 满载噪音(dB): ≤65
- 制动器: 1个交流制动
- 吊钩: 2个下(可旋转)
- 悬挂方式: 可调节抱卡固定安装, 可选装运行跑车式
- 安装方式: 固定式
- 塑料手柄: 无
- 防护等级: IP55
- 不含链条的重量(kg): 141 - 176
- 电机功率(KW): 3
- 电流消耗(A): 7
- 机械等级/FEM9.511: 1Bm/25%ED
- 限位方式: 上下电子触点限位
- 颜色: 黑色, 色号RAL 9005 哑光

选装配置:

- **编码器选装** 安装增量式编码器或预留编码器安装位 (低速链轮输出轴或高速电机轴)
- **控制手柄选装** 低压4位开关
- **称重检测选装** 称重传感器
- **链条表面处理选装** 镀锌 (白)
- **高压控制选装** 选装 一条高压主电源控制

Standard Configuration

- Model : HGA9 Pro-S 2000
- SWL acc. : 2000 Kg
- Lifting speed (m/min) : 6
- supply voltage :
220-440V、3ph、50/60Hz (See P11)
- Control voltage: 36V low voltage control
- Power supply cable : 1m power supply cable, CEE-16A/4 cord
- Chain acc. EN818-7 (mm) : 10*30
- Chain net weight (Kg/m) : 2.2
- Grade of chain : G80
- Chain surface : Parkerized (black)
- Chain falls : 2
- Chain Guide : Precise chain guide with 4-pocket chain wheel
- Chain bag : 1 textile chain bag, detachable, ≤30 meters
- Double hook spacing: 500-1500mm(Outside the range can be customized individually)
- Full load noise level (db) : ≤65
- Brake: 1AC brake
- Load hook: 2-down / turnable
- Suspension: Adjustable holding card fixed installation, optional running sports car type
- Mounting position: stationary
- Plastic handles: without
- Protection level: IP55
- Weight without chain (kg): 141-176
- Motor power (KW) : ca.3
- Current consumption (A): ca.7
- Mechanism class /FEM9.511: 1Bm/ 25% ED
- Limit mode: Upper and lower electronic contact limit
- Color:black, RAL 9005 matt

Optional:

- **Encoder Optional** Incremental encoder or reserved encoder mounting position (low speed sprocket output shaft or high speed motor shaft)
- **Controlling handle Optional** Low voltage 4-position switch
- **Load detection Optional** Load cell
- **Chain surface treatment Optional** Galvanized (white)
- **High voltage control Optional** Install a high voltage main power supply to control

HGA9 Pro-S 500 尺寸表/SIZE CHART

外形尺寸/Dimensions

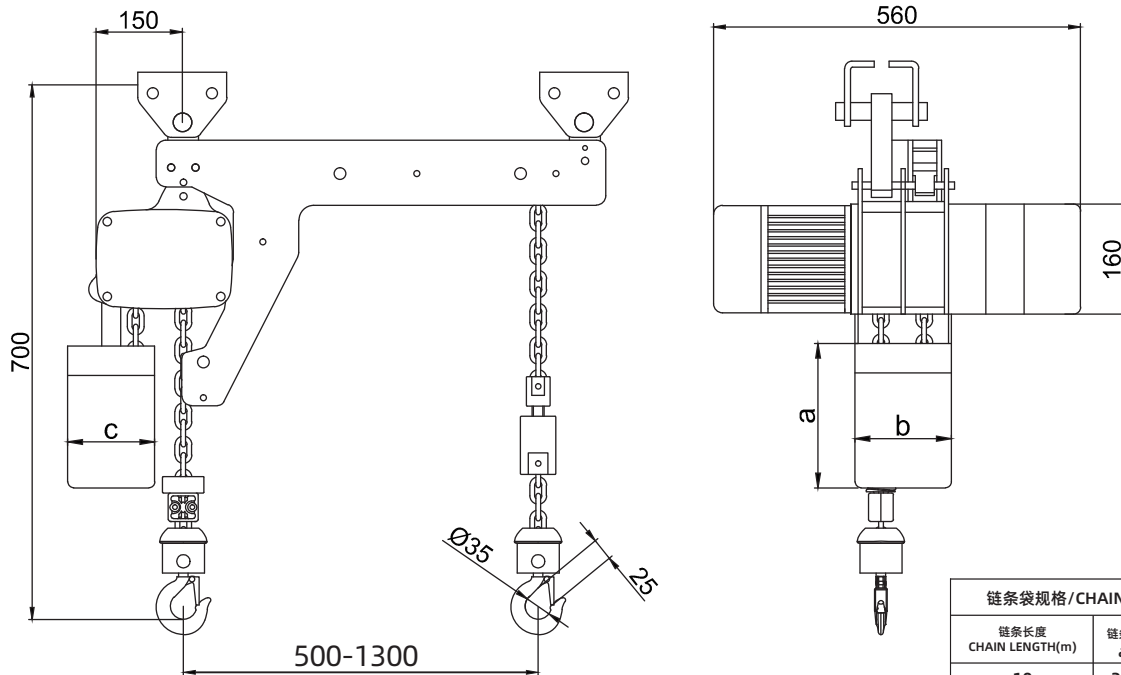

注：钩间距1300以上可单独定制

下钩组件/Lower hook assembly

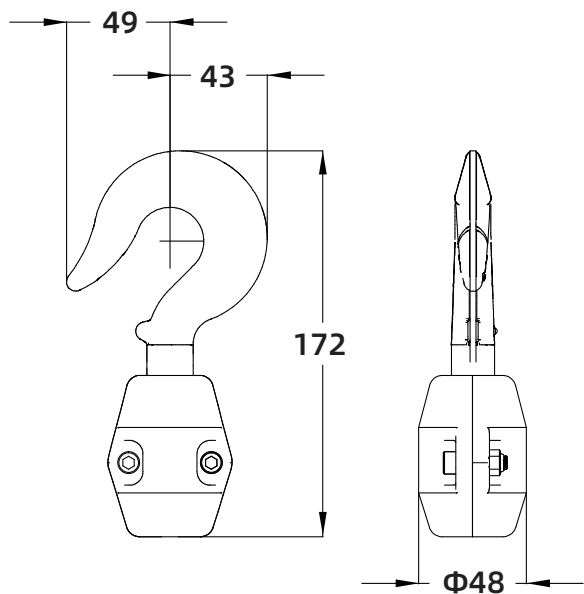

吊钩规格型号 HOOK SPECIFICATION	a1	b1	b2	d	h1	h2	B1	B2
HG-D-0.5T	25	7	7	35	29	27	17	17

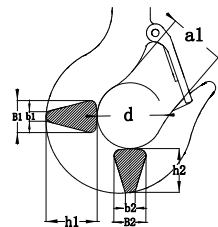

注：单位mm/Note:Unit mm

HGA9 Pro-S 1000 尺寸表/SIZE CHART

外形尺寸/Dimensions

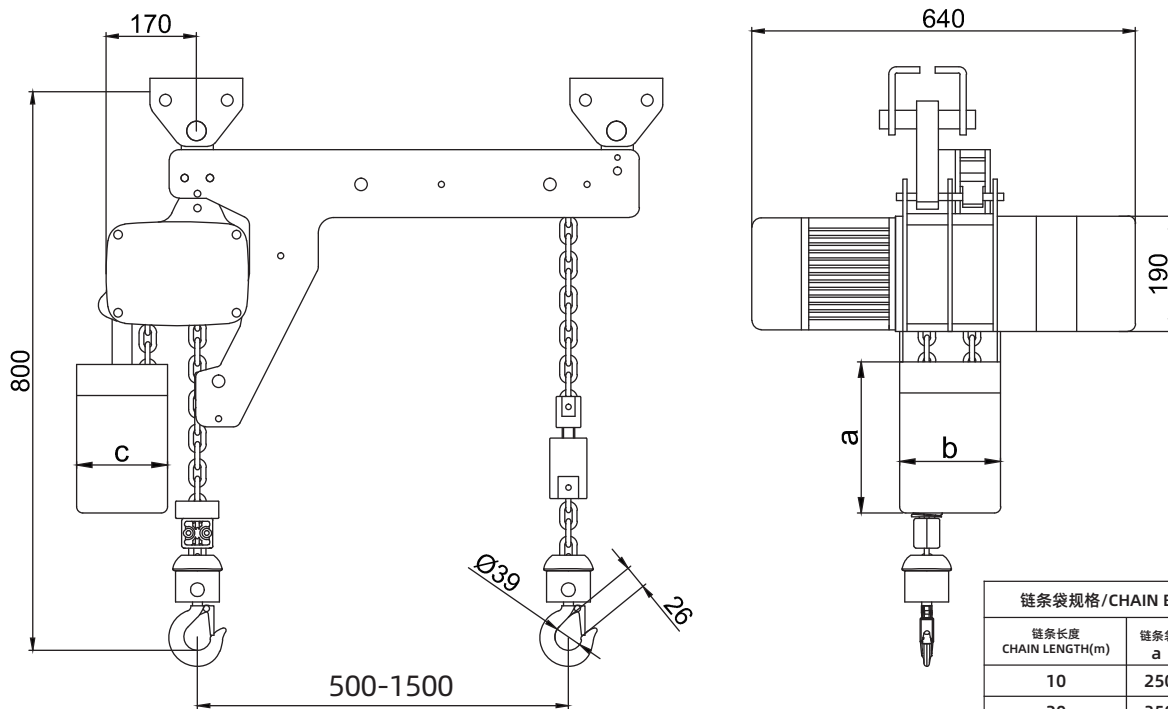

链条袋规格 / CHAIN BAG SPECIFICATION			
链条长度 CHAIN LENGTH(m)	链条袋尺寸 / CHAIN BAG SIZE(mm)		
	a	b	c
10	250	200	150
20	350	200	150
30	450	200	150

注：钩间距1500以上可单独定制

下钩组件/Lower hook assembly

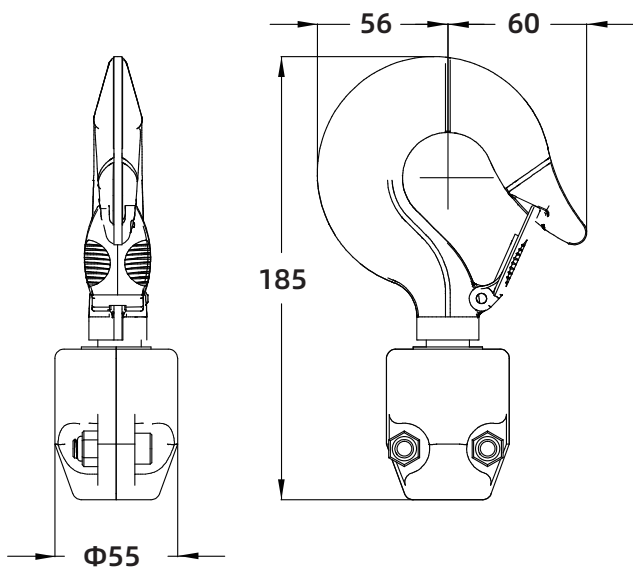

吊钩规格型号 HOOK SPECIFICATION	a1	b1	b2	d	h1	h2	B1	B2
HG-D-1T	26	7	7	39	37	35	21	21

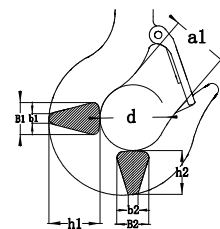

注：单位mm/Note:Unit mm

HGA9 Pro-5 2000 尺寸表/SIZE CHART

外形尺寸/Dimensions

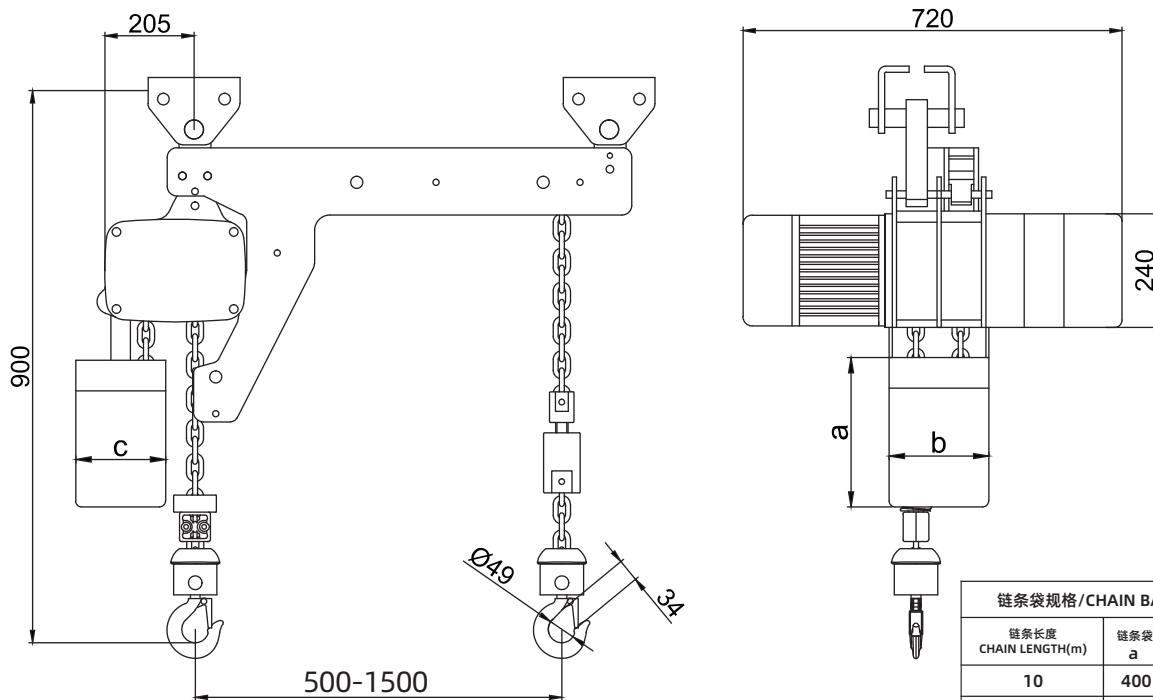

链条袋规格/CHAIN BAG SPECIFICATION			
链条长度 CHAIN LENGTH(m)	链条袋尺寸/CHAIN BAG SIZE(mm)		
	a	b	c
10	400	210	210
20	600	210	210
30	800	210	210

注：钩间距1500以上可单独定制

下钩组件/Lower hook assembly

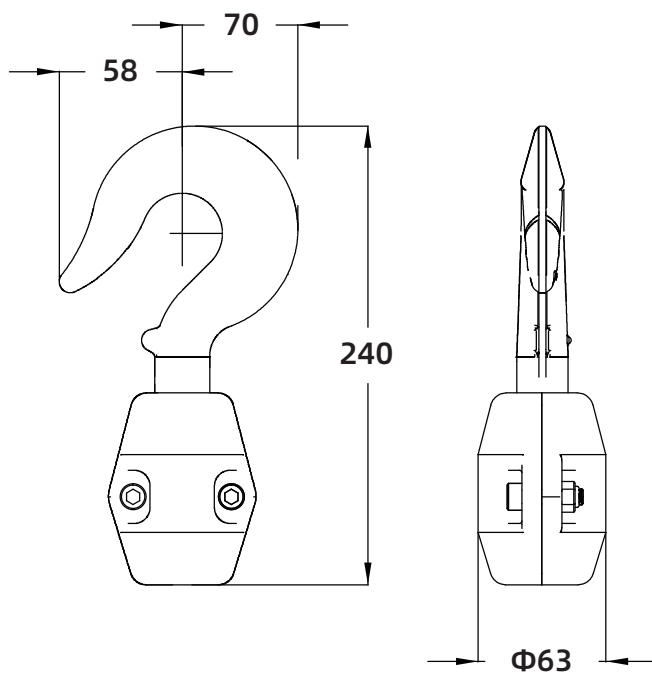

吊钩规格型号 HOOK SPECIFICATION	a1	b1	b2	d	h1	h2	B1	B2
HG-D-2T	34	16	16	49	45	42	33	33

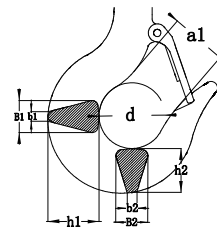

注：单位mm/Note:Unit mm

产品结构表/PRODUCT STRUCTURE

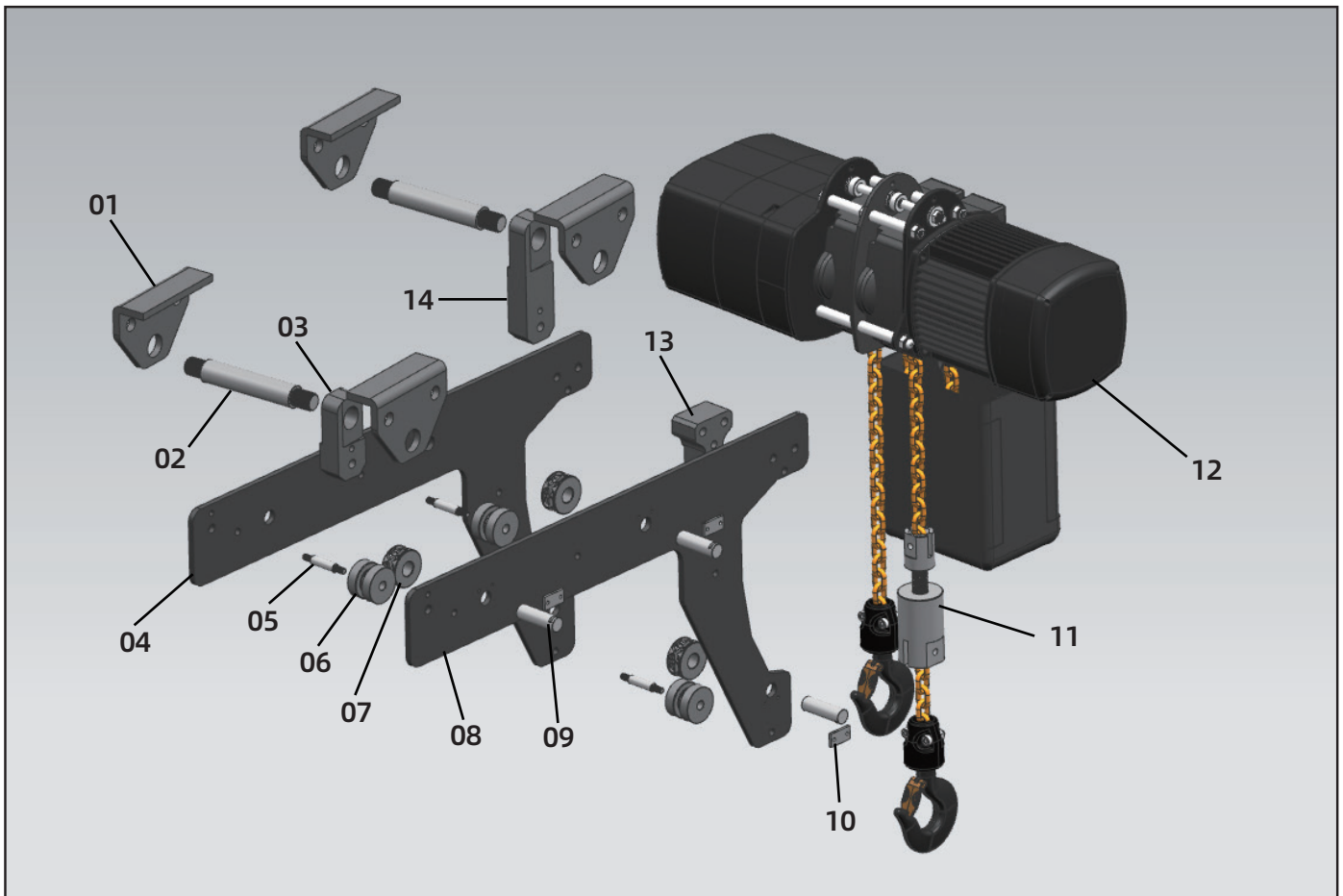

01:轨道抱卡	02:连接轴	03:副连接块	04:后墙板	05:过轮轴/支杆	06:过轮
07:游轮	08:前墙板	09:游轮轴	10:游轮轴卡板	11:副钩微调装置	12:电动葫芦机体
13:葫芦连接件	14:主连接块				

01:Orbital holders	02:Connecting shafts	03:Sub-connecting blocks	04:back wall panels	05:Over axles/struts	06:Over the wheel
07:Cruises	08:Front wall panels	09:Cruise ship shaft	10:Cruise ship shaft pallets	11:Auxiliary hook fine-tuning device	12:Electric hoist body
13:Hoist connectors	14:Main connection block				

电器线路图/Electrical wiring diagram

低压控制-3Ph+PE/Low voltage directly control-3Ph+PE

图5/Figure 5

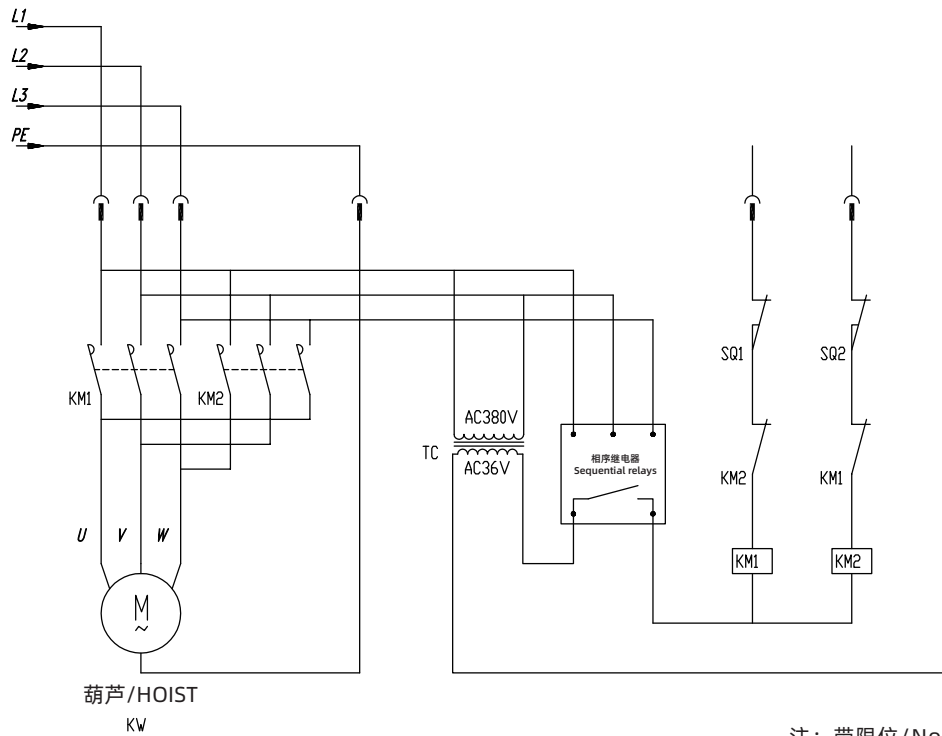

注：带限位/Note: with limit switch

高压控制-3Ph+PE/High voltage directly control-3Ph+PE

图6/Figure 6

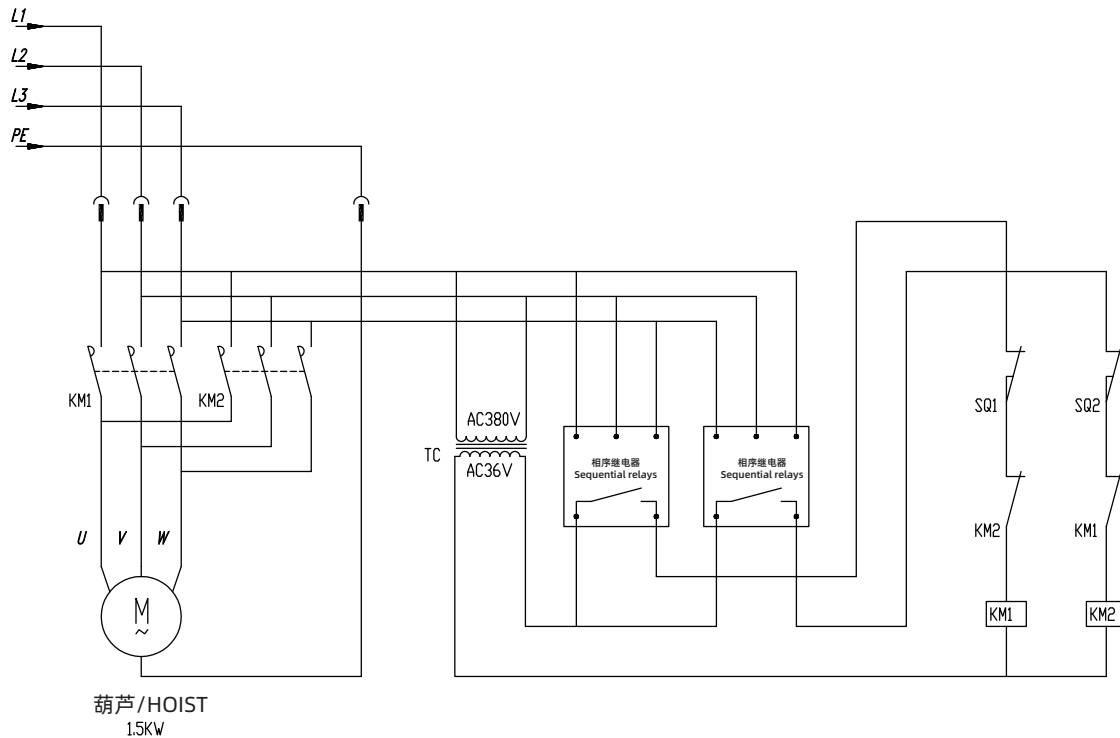

注：带限位/Note: with limit switch